

LED OEM CATALOGUE

2018

idalux[®]
for a bright future

www.idalux.com.tr



High Efficiency Lighting and Automation Solutions



LIGHTING APPLICATIONS:

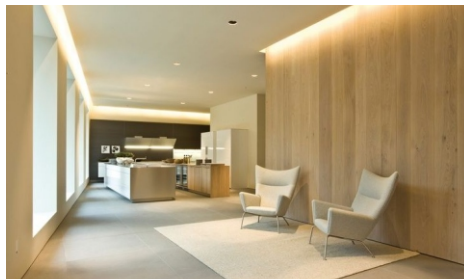

ABOUT COMPANY

Dear Partners,

AQL Technology Limited is a fast growing company whose primary focus is to deliver the latest technology in lighting to our customers. Beside of the super products, we also provide them with perfect solution and creative idea according to their requirements and expectation on the lighting environment.

Our products are suitable for all areas including indoor lighting/decorating, commercial and residential lighting. Our work and service start from Western Europe to Saudi Arabia, and expanding to all over the world.

AQL is engaged in all kinds of newly coming lighting products. At mean time, we are also providing power supply, controllers, connectors etc. which are essential in lighting system. This is creating a convenient one-stop shopping center for our customers.

We are devoted to providing the best products and service at the lowest cost. The tenet of our business is to achieve a mutual benefit together with our customers. So trust us, you can be sure of a win-win prospect.

You have individual demands for your project. We have the most suitable solution. No matter it's a combination of energy efficiency, longlife, free of toxic substances and low maintenance or all of those combined. With our comprehensive support you will not only reduce the energy requirements of your installation, but also your own work-load. We are at your side and work in close cooperation with you in all phases of the implementation of sustainable, efficient state-of-the-art projects, and support you in your decisions. The right partners make all the difference.

Welcome to AQL !!

Ömer YEDİTEPE

General Manager

AQL Teknoloji Aydınlatma İth. İhr. San. ve Tic. Ltd. Şti. TURKEY

AQL Technology Limited - HONG KONG

SHENZHEN AIQILI Lighting Technoloyg Limited - CHINA



We started in Hong Kong



We are in Turkey



We are in Bursa



VISION

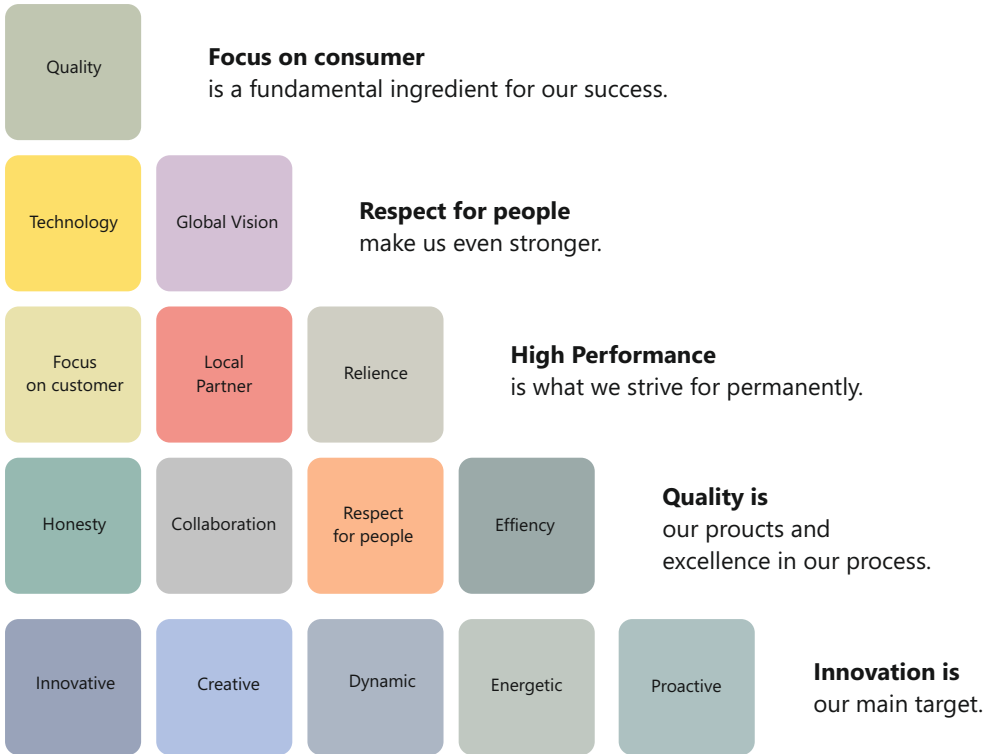

and our main vision is optimum energy saving and environmental sensitivity



INDEX

CONSTANT CURRENT LED MODULES

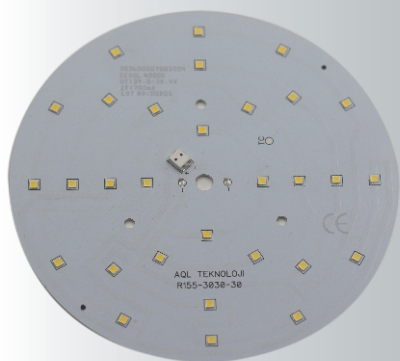

* R38-3030-4	Page 5
* R48-3030-4	Page 6
* R48-3030-6	Page 7
* R60-3030-6	Page 8
* R60-3030-9	Page 9
* R80-3030-9	Page 10
* R85-3030-12	Page 11
* R105-3030-20	Page 12
* R112-3030-12	Page 13
* R120-3030-20	Page 14
* R155-3030-30	Page 15
* L24X560-5630-44	Page 16
* L24X560-5630-80	Page 17
* L530X67-2835-144	Page 18

CONSTANT VOLTAGE LED MODULES



* L490X10-5630-30/12	Page 20
* L490X10-5630-30/24	Page 21
* L490X12-2835-60/24	Page 22

CONNECTOR and STECK SYSTEMS

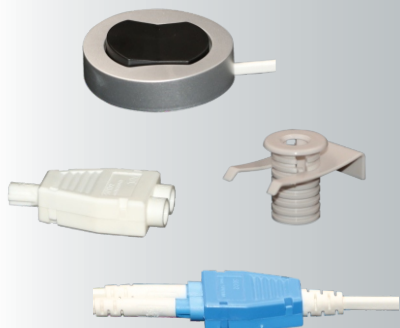

* Connector System 24V 10A	Page 24
* Connector System 50V 10A	Page 26
* Connector System 250V 2.5A	Page 28
* Switch System	Page 30

TECHNICAL NOTES:

Output of LED lighting flux current may vary $\pm 5\%$.

Power consumption is approximately. Drivers and LED packets may vary according to the manufacturers value.

Constant Current Led Modules

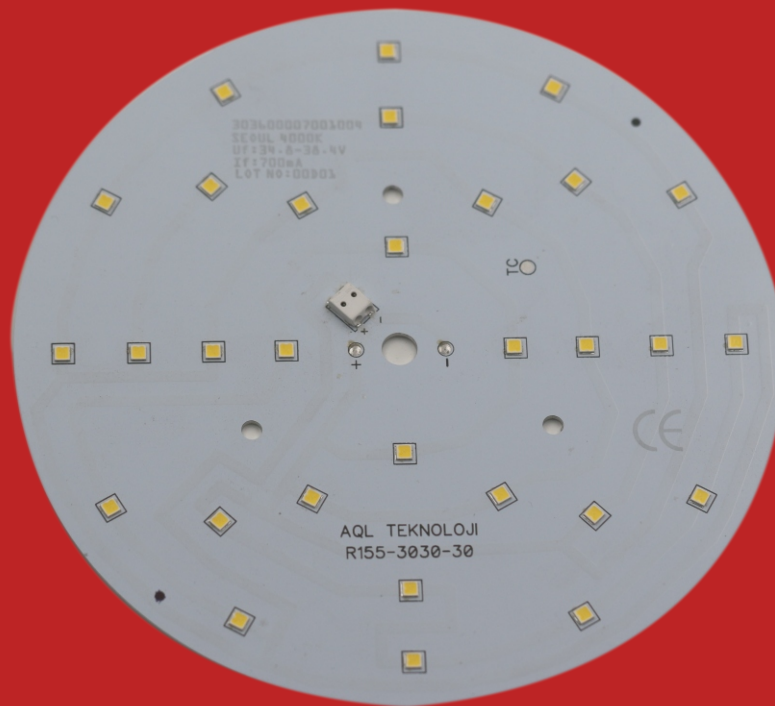

right time, right place !

Perfectly suitable to replace traditional spot lights
Perfect heat reduction technology
Optional dimming methods: Triac DIM, 1-10V, DALI, DSI
CE, RoHS approval
The narrow colour tolerance

High Efficiency Lighting and Automation Solutions

idalux®
for a bright future

ROUND 303600001

Constant Current R38-3030-4 LED Module
3 Watt

DESCRIPTION:

- Aluminium PCB design.
- High efficiency.
- Low energy consumption.
- Narrow colour tolerance.
- No UV or infrared radiation.
- 3 years warranty time.
- Certificates: CE, ROHs.

For Indoor and Outdoor Applications

High Efficiency Lighting and Automation Solutions

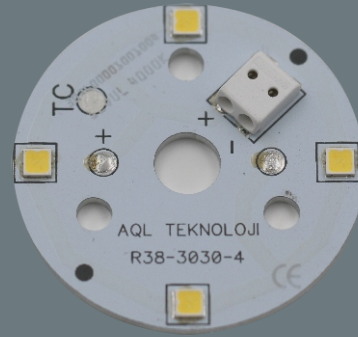

Module Dimensions	Size/Diameter	Material	Chip	LED	CRI	Serial	Parallel	Temperature Ambient Ta°C
R38-3030-4	Ø 38 mm	1.6 mm Alu	3030	4	≥80	2	2	-15°C+45°C

Code	Lumen Output		Voltage	CCT	Connection
	250mA	300mA			
303600001002009	335 Lm	354 Lm	11.6....12.8 Volt	2700 Kelvin	wiring
303600001002001	339 Lm	366 Lm	11.6....12.8 Volt	3000 Kelvin	wiring
303600001002002	383 Lm	417 Lm	11.6....12.8 Volt	4000 Kelvin	wiring
303600001002003	387 Lm	405 Lm	11.6....12.8 Volt	6500 Kelvin	wiring

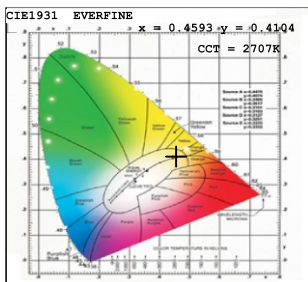

CIE1931 Chromaticity Diagram

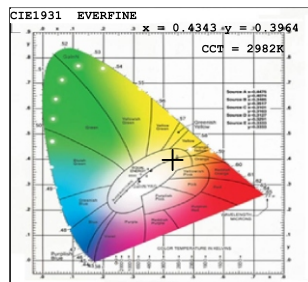

CIE1931 Chromaticity Diagram

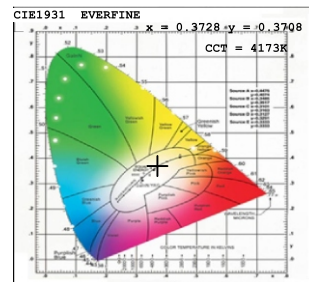

CIE1931 Chromaticity Diagram

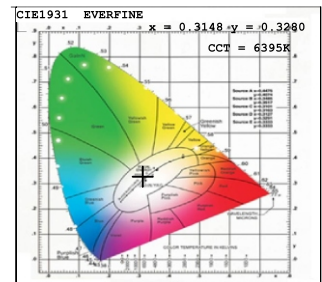

CIE1931 Chromaticity Diagram

TECHNICAL DRAWING

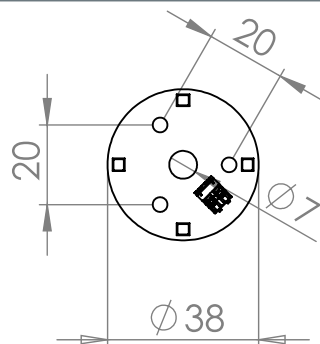

PCB-38-3030-4



ROUND 303600002

Constant Current R48-3030-4 LED Module 3 Watt

DESCRIPTION:

Aluminium PCB design.
High efficiency.
Low energy consumption.
Narrow colour tolerance.
No UV or infrared radiation.
3 years warranty time.
Certificates: CE, ROHs.

For Indoor and Outdoor Applications

High Efficiency Lighting and Automation Solutions

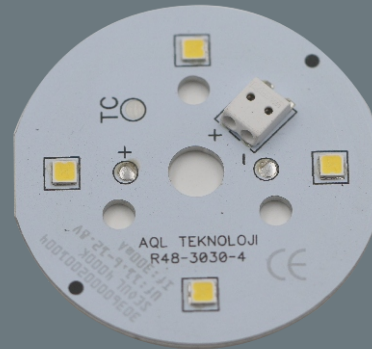

Module Dimensions	Size/Diameter	Material	Chip	LED	CRI	Serial	Parallel	Temperature Ambient Ta°C
R48-3030-4	Ø 48 mm	1.6 mm Alu	3030	4	≥80	2	2	-15°C+45°C

Code	Lumen Output		Voltage	CCT	Connection
	250mA	300mA			
303600002002009	371 Lm	423 Lm	11.6....12.8 Volt	2700 Kelvin	wiring
303600002002001	386 Lm	424 Lm	11.6....12.8 Volt	3000 Kelvin	wiring
303600002002002	424 Lm	482 Lm	11.6....12.8 Volt	4000 Kelvin	wiring
303600002002003	444 Lm	499 Lm	11.6....12.8 Volt	6500 Kelvin	wiring

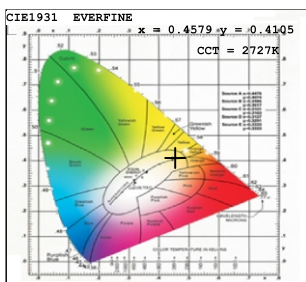

CIE1931 Chromaticity Diagram

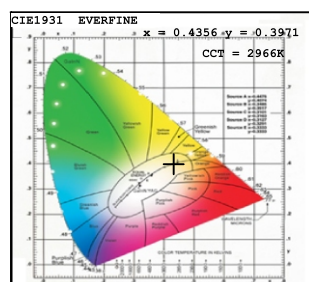

CIE1931 Chromaticity Diagram

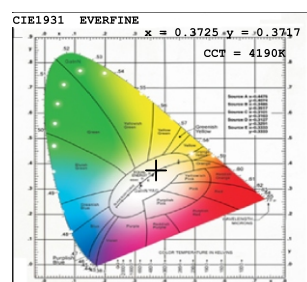

CIE1931 Chromaticity Diagram

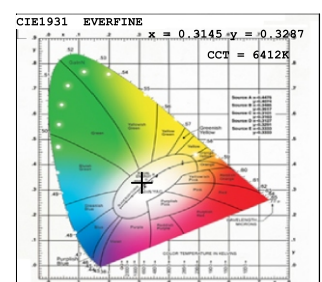

CIE1931 Chromaticity Diagram

TECHNICAL DRAWING

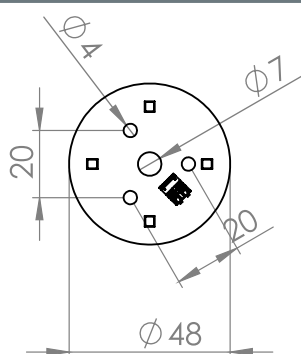

PCB-48-3030-4



ROUND 303600003

Constant Current R48-3030-6 LED Module
4.5 Watt

DESCRIPTION:

- Aluminium PCB design.
- High efficiency.
- Low energy consumption.
- Narrow colour tolerance.
- No UV or infrared radiation.
- 3 years warranty time.
- Certificates: CE, ROHs.

For Indoor and Outdoor Applications

High Efficiency Lighting and Automation Solutions

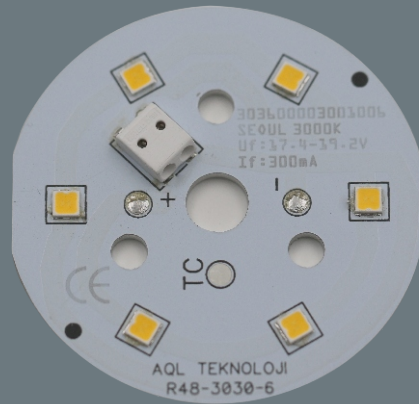

Module Dimensions	Size/Diameter	Material	Chip	LED	CRI	Serial	Parallel	Temperature Ambient Ta°C
R48-3030-6	Ø 48 mm	1.6 mm Alu	3030	6	≥80	3	2	-15°C+45°C

Code	Lumen Output		Voltage	CCT	Connection
	250mA	300mA			
303600003002009	554 Lm	728 Lm	17.4....19.2 Volt	2700 Kelvin	wiring
303600003002001	575 Lm	672 Lm	17.4....19.2 Volt	3000 Kelvin	wiring
303600003002002	640 Lm	740 Lm	17.4....19.2 Volt	4000 Kelvin	wiring
303600003002003	651 Lm	724 Lm	17.4....19.2 Volt	6500 Kelvin	wiring

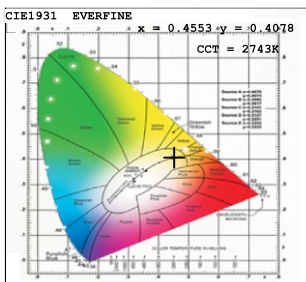

CIE1931 Chromaticity Diagram

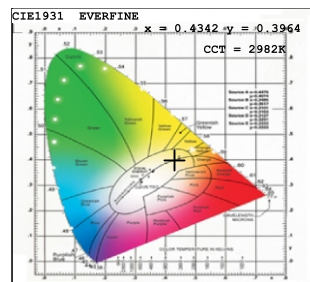

CIE1931 Chromaticity Diagram

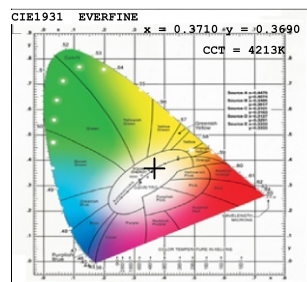

CIE1931 Chromaticity Diagram

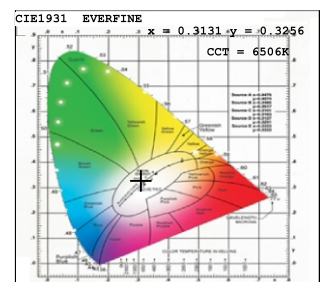

CIE1931 Chromaticity Diagram

TECHNICAL DRAWING

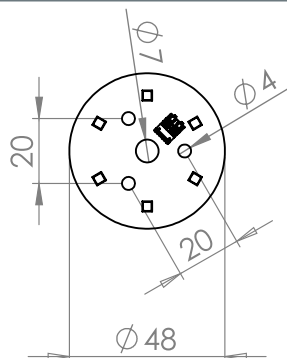

PCB-48-3030-6



ROUND 303600014

Constant Current R60-3030-6 LED Module
4.5 Watt

DESCRIPTION:

- Aluminium PCB design.
- High efficiency.
- Low energy consumption.
- Narrow colour tolerance.
- No UV or infrared radiation.
- 3 years warranty time.
- Certificates: CE, ROHs.

For Indoor and Outdoor Applications

High Efficiency Lighting and Automation Solutions

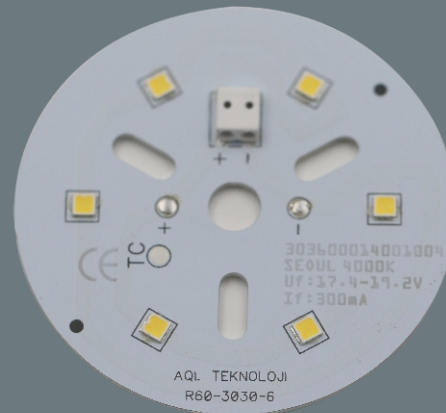

Module Dimensions	Size/Diameter	Material	Chip	LED	CRI	Serial	Parallel	Temperature Ambient Ta°C
R60-3030-6	Ø 60 mm	1.6 mm Alu	3030	6	≥80	3	2	-15°C+45°C

Code	Lumen Output		Voltage	CCT	Connection
	250mA	300mA			
303600014002009	565 Lm	667 Lm	17.4....19.2 Volt	2700 Kelvin	wiring
303600014002001	595 Lm	636 Lm	17.4....19.2 Volt	3000 Kelvin	wiring
303600014002002	656 Lm	738 Lm	17.4....19.2 Volt	4000 Kelvin	wiring
303600014002003	662 Lm	826 Lm	17.4....19.2 Volt	6500 Kelvin	wiring

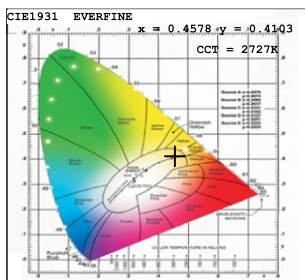

CIE1931 Chromaticity Diagram

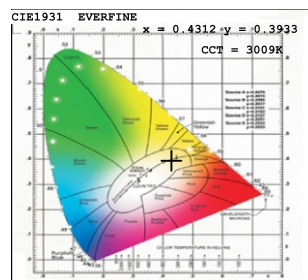

CIE1931 Chromaticity Diagram

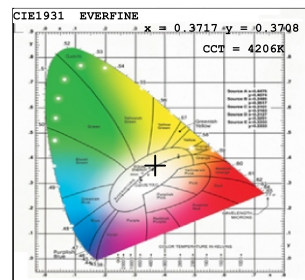

CIE1931 Chromaticity Diagram

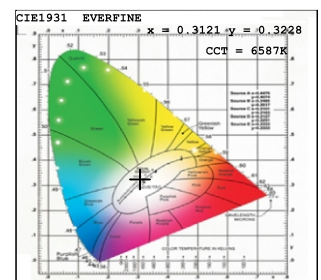

CIE1931 Chromaticity Diagram

TECHNICAL DRAWING

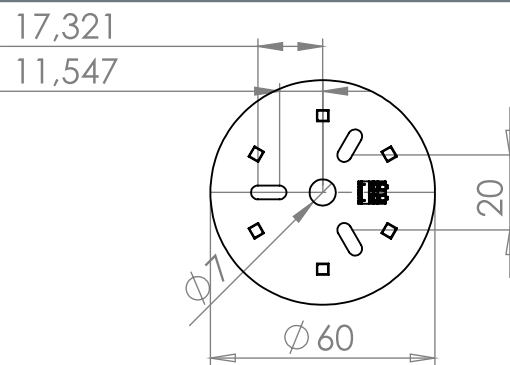

PCB-60-3030-6



ROUND 303600006

Constant Current R60-3030-9 LED Module
6.2 Watt

DESCRIPTION:

- Aluminium PCB design.
- High efficiency.
- Low energy consumption.
- Narrow colour tolerance.
- No UV or infrared radiation.
- 3 years warranty time.
- Certificates: CE, ROHs.

For Indoor and Outdoor Applications

High Efficiency Lighting and Automation Solutions

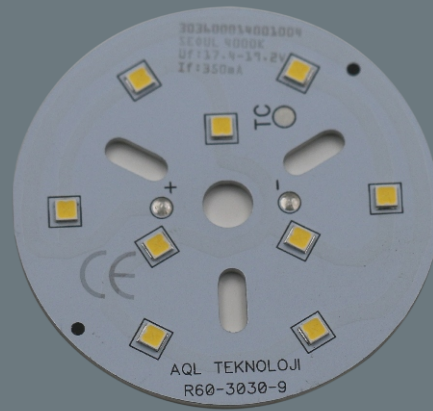

Module Dimensions	Size/Diameter	Material	Chip	LED	CRI	Serial	Parallel	Temperature Ambient Ta°C
R60-3030-9	Ø 60 mm	1.6 mm Alu	3030	9	≥80	3	3	-15°C+45°C

Code	Lumen Output		Voltage	CCT	Connection
	300mA	350mA			
303600006002009	593 Lm	683 Lm	17.4....19.2 Volt	2700 Kelvin	wiring
303600006002001	646 Lm	721 Lm	17.4....19.2 Volt	3000 Kelvin	wiring
303600006002002	720 Lm	805 Lm	17.4....19.2 Volt	4000 Kelvin	wiring
303600006002003	720 Lm	832 Lm	17.4....19.2 Volt	6500 Kelvin	wiring

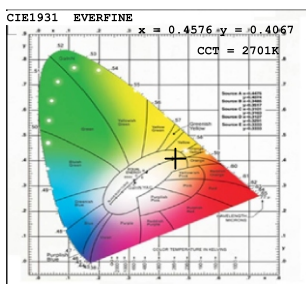

CIE1931 Chromaticity Diagram

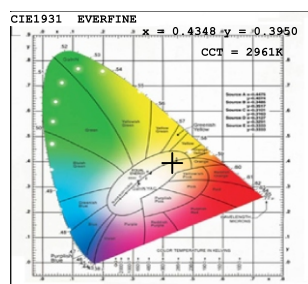

CIE1931 Chromaticity Diagram

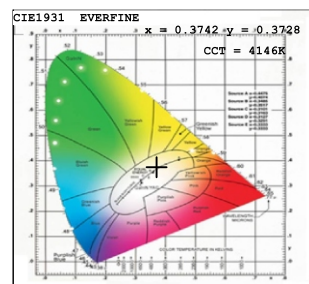

CIE1931 Chromaticity Diagram

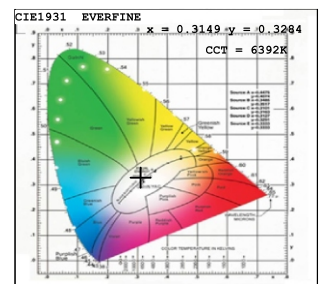

CIE1931 Chromaticity Diagram

TECHNICAL DRAWING

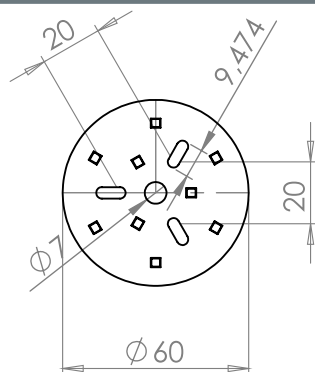

PCB-60-3030-9



ROUND 303600012

Constant Current R80-3030-9 LED Module
6.2 Watt

DESCRIPTION:

- Aluminium PCB design.
- High efficiency.
- Low energy consumption.
- Narrow colour tolerance.
- No UV or infrared radiation.
- 3 years warranty time.
- Certificates: CE, ROHs.

For Indoor and Outdoor Applications

High Efficiency Lighting and Automation Solutions

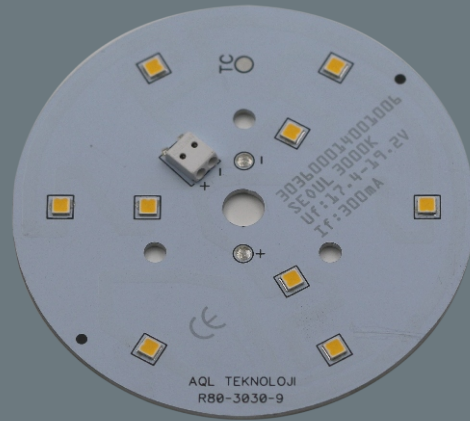

Module Dimensions	Size/Diameter	Material	Chip	LED	CRI	Serial	Parallel	Temperature Ambient Ta°C
R80-3030-9	Ø 80 mm	1.6 mm Alu	3030	9	≥80	3	3	-15°C+45°C

Code	Lumen Output		Voltage	CCT	Connection
	300mA	350mA			
303600012002001	720 Lm	812 Lm	17.4....19.2 Volt	3000 Kelvin	wiring
303600012002002	908 Lm	927 Lm	17.4....19.2 Volt	4000 Kelvin	wiring
303600012002003	815 Lm	890 Lm	17.4....19.2 Volt	6500 Kelvin	wiring

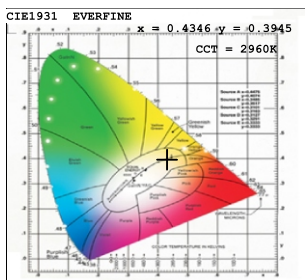

CIE1931 Chromaticity Diagram

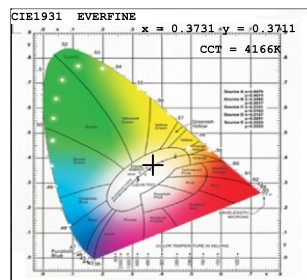

CIE1931 Chromaticity Diagram

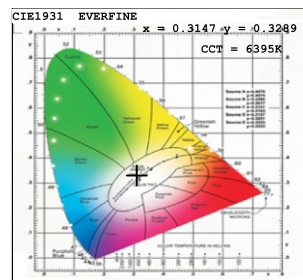

CIE1931 Chromaticity Diagram

TECHNICAL DRAWING

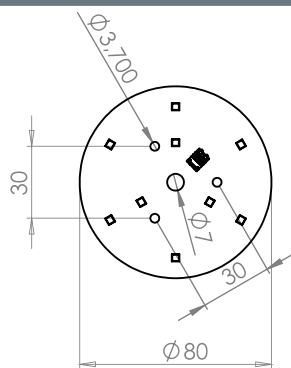

PCB-80-3030-9



ROUND 303600004

Constant Current R85-3030-12 LED Module
8.3 Watt

DESCRIPTION:

- Aluminium PCB design.
- High efficiency.
- Low energy consumption.
- Narrow colour tolerance.
- No UV or infrared radiation.
- 3 years warranty time.
- Certificates: CE, ROHs.

For Indoor and Outdoor Applications

High Efficiency Lighting and Automation Solutions

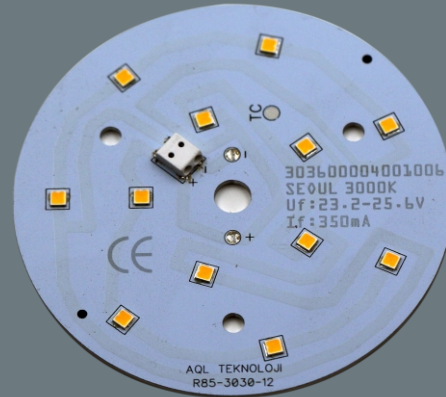

Module Dimensions	Size/Diameter	Material	Chip	LED	CRI	Serial	Parallel	Temperature Ambient Ta°C
R85-3030-12	Ø 85 mm	1.6 mm Alu	3030	12	≥80	4	3	-15°C+45°C

Code	Lumen Output		Voltage	CCT	Connection
	300mA	350mA			
303600004002009	815 Lm	941 Lm	23.2....25.6 Volt	2700 Kelvin	wiring
303600004002001	861 Lm	968 Lm	23.2....25.6 Volt	3000 Kelvin	wiring
303600004002002	967 Lm	1107 Lm	23.2....25.6 Volt	4000 Kelvin	wiring
303600004002003	999 Lm	1122 Lm	23.2....25.6 Volt	6500 Kelvin	wiring

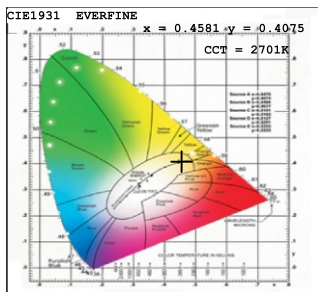

CIE1931 Chromaticity Diagram

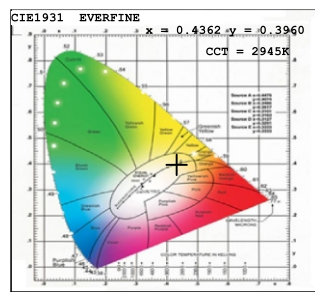

CIE1931 Chromaticity Diagram

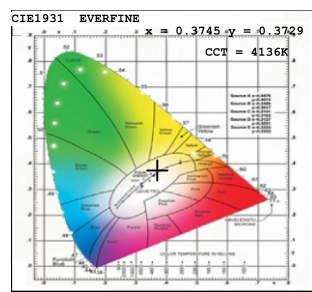

CIE1931 Chromaticity Diagram

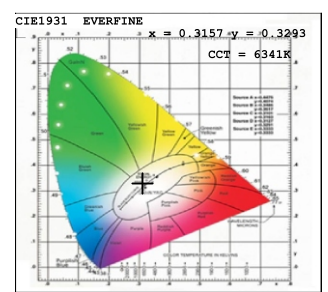

CIE1931 Chromaticity Diagram

TECHNICAL DRAWING

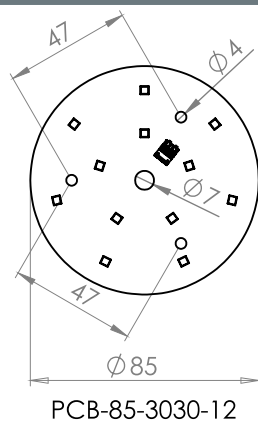

ROUND 303600005

Constant Current R105-3030-20 LED Module
10.2...15 Watt

DESCRIPTION:

- Aluminium PCB design.
- High efficiency.
- Low energy consumption.
- Narrow colour tolerance.
- No UV or infrared radiation.
- 3 years warranty time.
- Certificates: CE, ROHs.

For Indoor and Outdoor Applications

High Efficiency Lighting and Automation Solutions

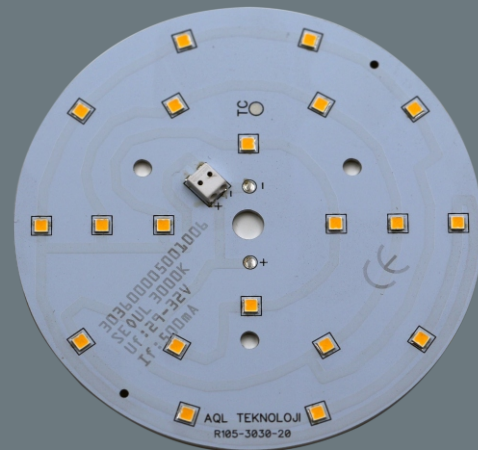

CRI
≥80

CO₂ ↓

3 years
WARRANTY

CE

LED
50.000
Hours

~~Pb~~

2700K
3000K
4000K
6500K

✓
RoHS
Compliant

Module Dimensions	Size/Diameter	Material	Chip	LED	CRI	Serial	Parallel	Temperature Ambient Ta°C
R105-3030-20	Ø 105 mm	1.6 mm Alu	3030	20	≥80	5	4	-15°C+45°C

Code	Lumen Output		Voltage	CCT	Connection
	350mA	500mA			
303600005002009	1409 Lm	1849 Lm	29....32 Volt	2700 Kelvin	wiring
303600005002001	1445 Lm	1885 Lm	29....32 Volt	3000 Kelvin	wiring
303600005002002	1589 Lm	2262 Lm	29....32 Volt	4000 Kelvin	wiring
303600005002003	1597 Lm	2163 Lm	29....32 Volt	6500 Kelvin	wiring

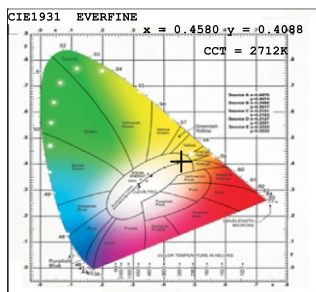

CIE1931 Chromaticity Diagram

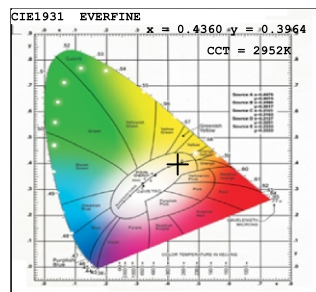

CIE1931 Chromaticity Diagram

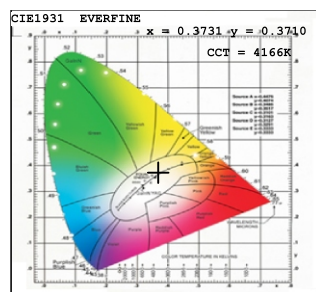

CIE1931 Chromaticity Diagram

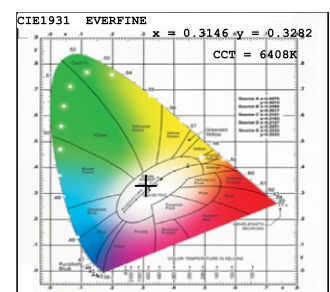

CIE1931 Chromaticity Diagram

TECHNICAL DRAWING

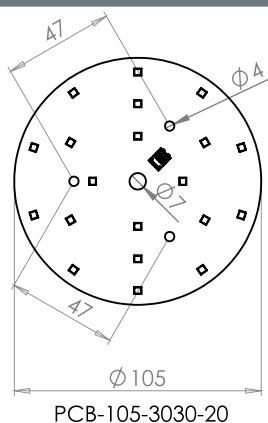

ROUND 303600013

Constant Current R112-3030-12 LED Module
8.3 Watt

DESCRIPTION:

- Aluminium PCB design.
- High efficiency.
- Low energy consumption.
- Narrow colour tolerance.
- No UV or infrared radiation.
- 3 years warranty time.
- Certificates: CE, ROHs.

For Indoor and Outdoor Applications

High Efficiency Lighting and Automation Solutions

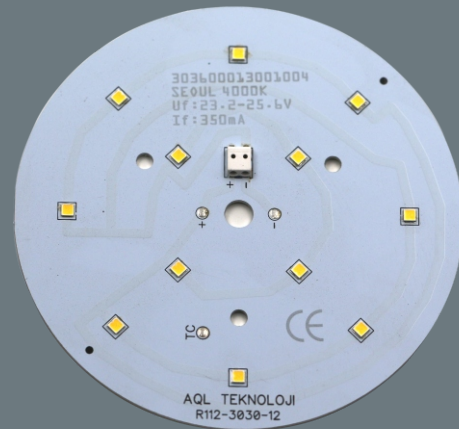

Module Dimensions	Size/Diameter	Material	Chip	LED	CRI	Serial	Parallel	Temperature Ambient Ta°C
R112-3030-12	Ø 112 mm	1.6 mm Alu	3030	12	≥80	4	3	-15°C+45°C

Code	Lumen Output		Voltage	CCT	Connection
	350mA	500mA			
303600013002009	981 Lm	1138 Lm	23.2....25.6 Volt	2700 Kelvin	wiring
303600013002001	981 Lm	1187 Lm	23.2....25.6 Volt	3000 Kelvin	wiring
303600013002002	1126 Lm	1280 Lm	23.2....25.6 Volt	4000 Kelvin	wiring
303600013002003	1125 Lm	1353 Lm	23.2....25.6 Volt	6500 Kelvin	wiring

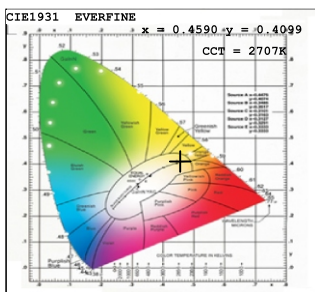

CIE1931 Chromaticity Diagram

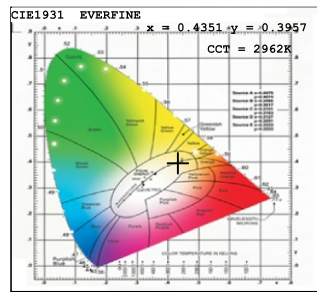

CIE1931 Chromaticity Diagram

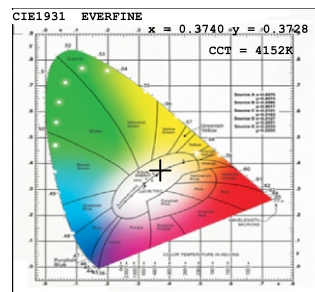

CIE1931 Chromaticity Diagram

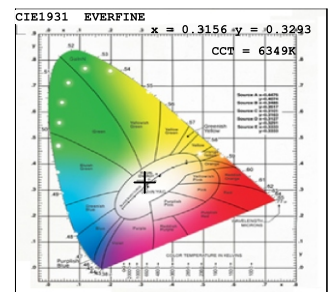

CIE1931 Chromaticity Diagram

TECHNICAL DRAWING

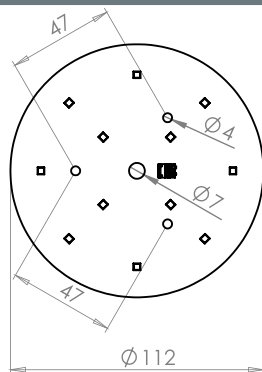

PCB-112-3030-12



ROUND 303600010

Constant Current R120-3030-20 LED Module
15 Watt

DESCRIPTION:

- Aluminium PCB design.
- High efficiency.
- Low energy consumption.
- Narrow colour tolerance.
- No UV or infrared radiation.
- 3 years warranty time.
- Certificates: CE, ROHs.

For Indoor and Outdoor Applications

High Efficiency Lighting and Automation Solutions

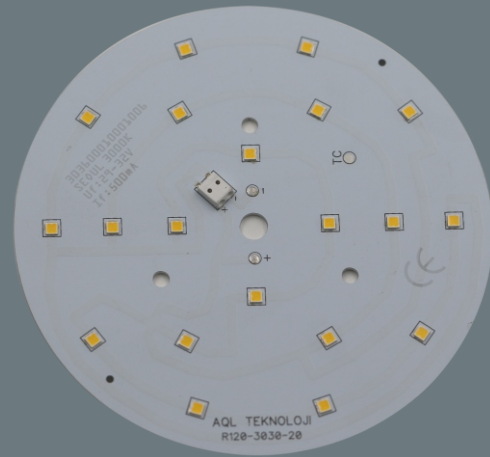

Module Dimensions	Size/Diameter	Material	Chip	LED	CRI	Serial	Parallel	Temperature Ambient Ta°C
R120-3030-20	Ø 120 mm	1.6 mm Alu	3030	20	≥80	5	4	-15°C+45°C

Code	Lumen Output		Voltage	CCT	Connection
	500mA	700mA			
303600010002009	1733 Lm	2099 Lm	29....32 Volt	2700 Kelvin	wiring
303600010002001	1743 Lm	2308 Lm	29....32 Volt	3000 Kelvin	wiring
303600010002002	2025 Lm	2535 Lm	29....32 Volt	4000 Kelvin	wiring
303600010002003	2022 Lm	2693 Lm	29....32 Volt	6500 Kelvin	wiring

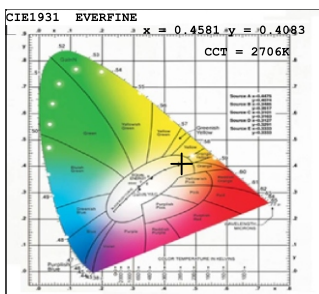

CIE1931 Chromaticity Diagram

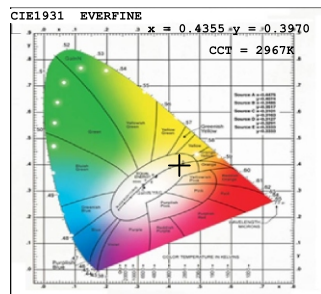

CIE1931 Chromaticity Diagram

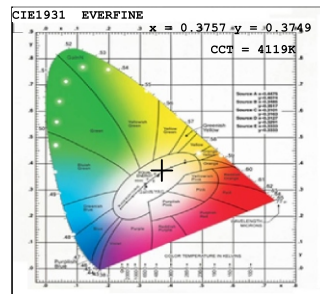

CIE1931 Chromaticity Diagram

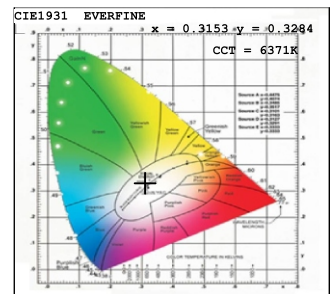

CIE1931 Chromaticity Diagram

TECHNICAL DRAWING

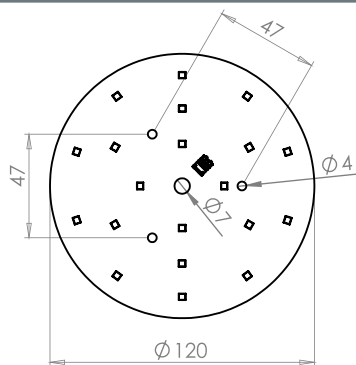

PCB-120-3030-20



ROUND 303600007

Constant Current R155-3030-30 LED Module
18...26 Watt

DESCRIPTION:

- Aluminium PCB design.
- High efficiency.
- Low energy consumption.
- Narrow colour tolerance.
- No UV or infrared radiation.
- 3 years warranty time.
- Certificates: CE, ROHs.

For Indoor and Outdoor Applications

High Efficiency Lighting and Automation Solutions

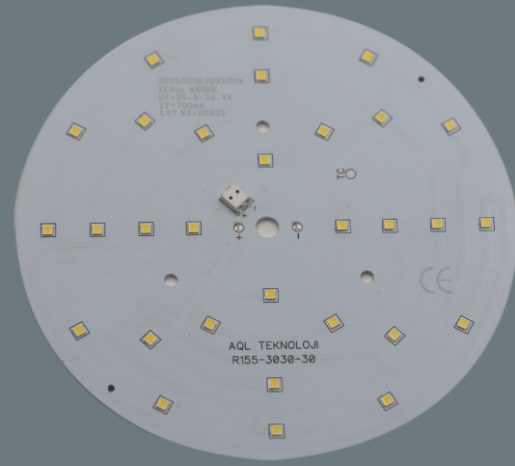

Module Dimensions	Size/Diameter	Material	Chip	LED	CRI	Serial	Parallel	Temperature Ambient Ta°C
R155-3030-30	Ø 155 mm	1.6 mm Alu	3030	30	≥80	6	5	-15°C+45°C

Code	Lumen Output		Voltage	CCT	Connection
	500mA	700mA			
303600070002009	2372 Lm	3136 Lm	34.8...38.4 Volt	2700 Kelvin	wiring
303600070002001	2450 Lm	2912 Lm	34.8...38.4 Volt	3000 Kelvin	wiring
303600070002002	2636 Lm	3233 Lm	34.8...38.4 Volt	4000 Kelvin	wiring
303600070002003	2743 Lm	3385 Lm	34.8...38.4 Volt	6500 Kelvin	wiring

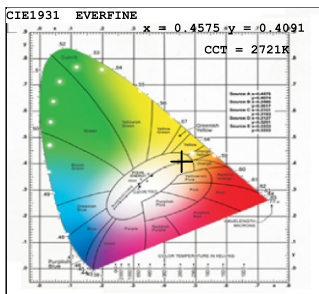

CIE1931 Chromaticity Diagram

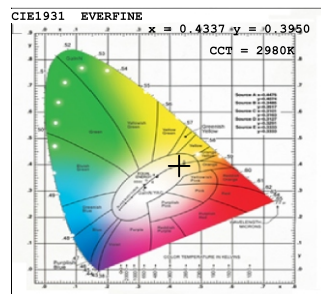

CIE1931 Chromaticity Diagram

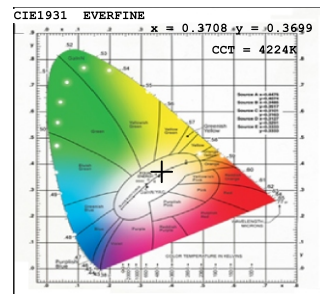

CIE1931 Chromaticity Diagram

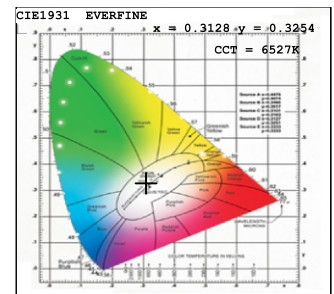

CIE1931 Chromaticity Diagram

TECHNICAL DRAWING

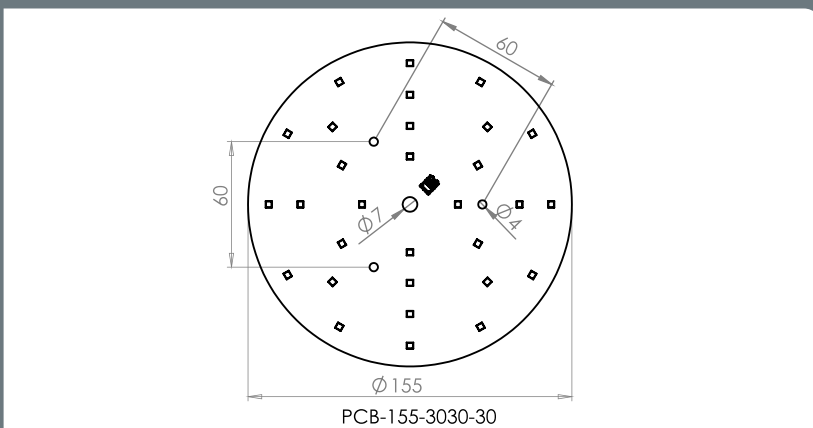

LINEAR 30360022

Constant Current L530X67-2835-144
LED Module 28 Watt

DESCRIPTION:

Aluminium PCB design.
High efficiency.
Low energy consumption.
Narrow colour tolerance.
No UV or infrared radiation.
3 years warranty time.
Certificates: CE, ROHs.

For Indoor and Outdoor Applications

High Efficiency Lighting and Automation Solutions

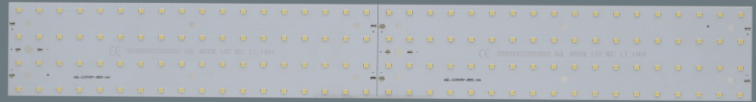

Module Dimensions	Size/Diameter	Material	Chip	LED	CRI	Serial	Parallel	Temperature Ambient Ta°C
L530X67-2835-144	530X67 mm	1.2 mm Alu	2835	144	≥80	18	8	-15°C+45°C

Code	CCT	Voltage	Current	Lumen Output	Power	Connection
303600022002001	3000 Kelvin	40-48 Volt	0.7 A	1800-2000 Lm	28 Watt	wiring
303600022002002	4000 Kelvin					
303600022002003	6500 Kelvin					

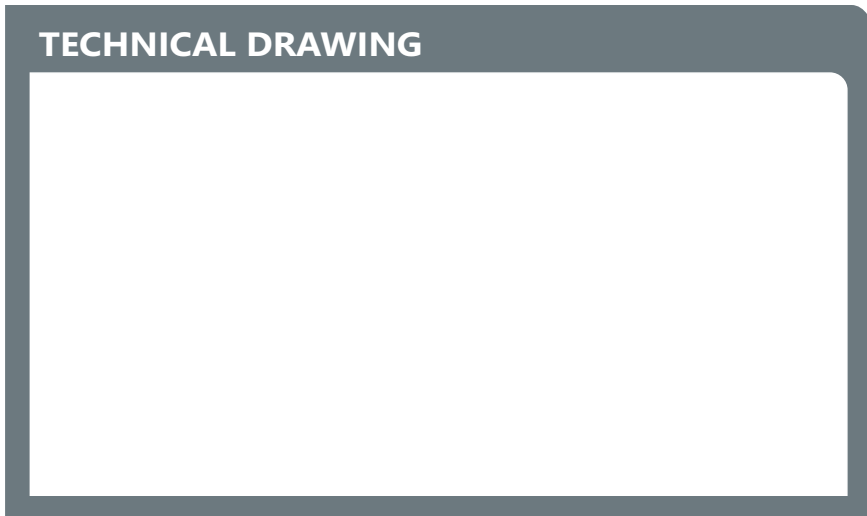

Constant Voltage Led Modules

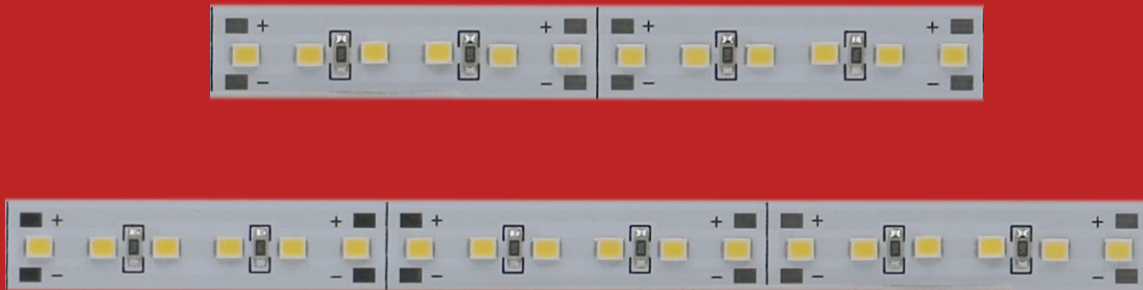

right time, right place !

High efficiency
Perfect heat reduction technology
Optional dimming methods: Triac DIM, 1-10V, DALI, DSI
CE, RoHS approval
The narrow colour tolerance

LINEAR 303600026

Constant Voltage L490X10-5630-30/12
LED Module 5 Watt

DESCRIPTION:

Aluminium PCB design.
High efficiency.
Low energy consumption.
Narrow colour tolerance.
No UV or infrared radiation.
3 years warranty time.
Certificates: CE, ROHS.

For Indoor and Outdoor Applications

High Efficiency Lighting and Automation Solutions



Module Dimensions	Size/Diameter	Material	Chip	LED	CRI	Serial	Parallel	Temperature Ambient Ta°C
L490X10-5630-30	490X10 mm	1 mm Alu	5630	30	≥80	1	10	-15°C+45°C

Code	CCT	Voltage	Current	Lumen Output	Power	Connection
303600026002001	3000 Kelvin					
303600026002002	4000 Kelvin	12 Volt	0.45 A	550-600 Lm	5 Watt	wiring
303600026002003	6500 Kelvin					

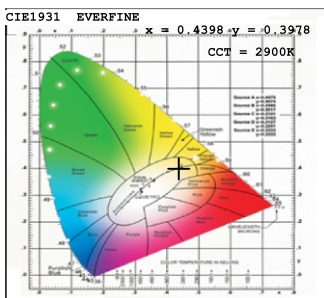

CIE1931 Chromaticity Diagram

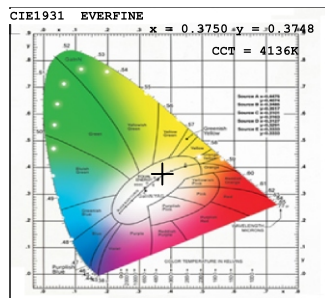

CIE1931 Chromaticity Diagram

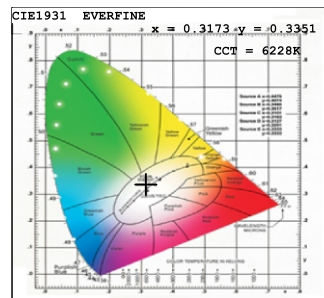

CIE1931 Chromaticity Diagram

TECHNICAL DRAWING

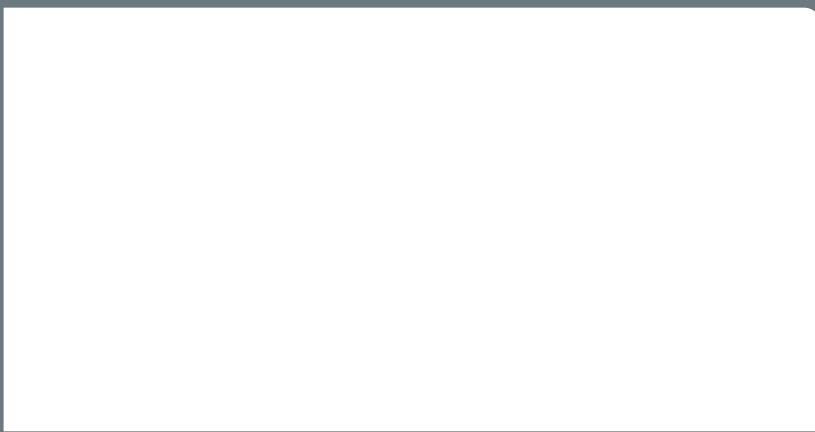

LINEAR 303600027

Constant Voltage L490X10-5630-30/24
LED Module 5 Watt

DESCRIPTION:

- Aluminium PCB design.
- High efficiency.
- Low energy consumption.
- Narrow colour tolerance.
- No UV or infrared radiation.
- 3 years warranty time.
- Certificates: CE, ROHs.

For Indoor and Outdoor Applications

High Efficiency Lighting and Automation Solutions



Module Dimensions	Size/Diameter	Material	Chip	LED	CRI	Serial	Parallel	Temperature Ambient Ta°C
L490X10-5630-30	490X10 mm	1 mm Alu	5630	30	≥80	1	5	-15°C+45°C

Code	CCT	Voltage	Current	Lumen Output	Power	Connection
303600027002001	3000 Kelvin					
303600027002002	4000 Kelvin	24 Volt	0.23 A	550-650 Lm	5 Watt	wiring
303600027002003	6500 Kelvin					

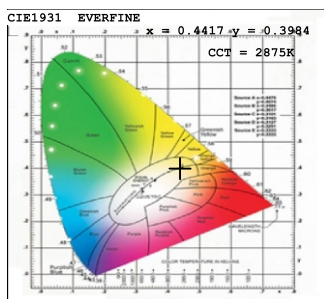

CIE1931 Chromaticity Diagram

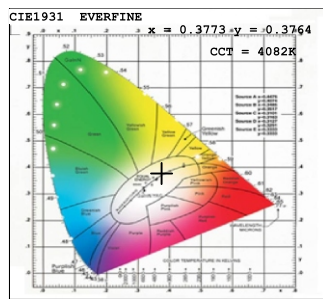

CIE1931 Chromaticity Diagram

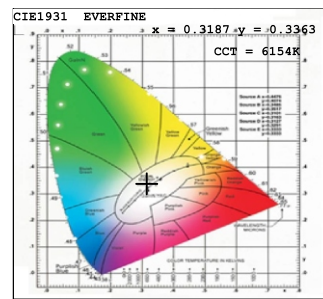

CIE1931 Chromaticity Diagram

TECHNICAL DRAWING

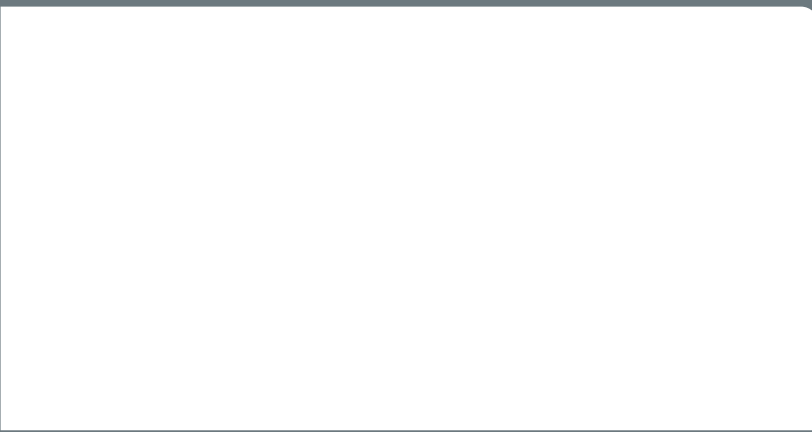

LINEAR 303600023

Constant Voltage L490X12-2835-60/24
LED Module 8 Watt

DESCRIPTION:

- Aluminium PCB design.
- High efficiency.
- Low energy consumption.
- Narrow colour tolerance.
- No UV or infrared radiation.
- 3 years warranty time.
- Certificates: CE, ROHS.

For Indoor and Outdoor Applications

High Efficiency Lighting and Automation Solutions

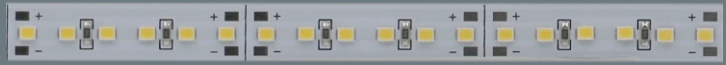

Module Dimensions	Size/Diameter	Material	Chip	LED	CRI	Serial	Parallel	Temperature Ambient Ta°C
L490X12-2835-60	490X12 mm	1 mm Alu	2835	60	≥80	1	5	-15°C+45°C

Code	CCT	Voltage	Current	Lumen Output	Power	Connection
303600023002001	3000 Kelvin	24 Volt	0.3 A	650-720 Lm	8 Watt	wiring
303600023002002	4000 Kelvin					
303600023002003	6500 Kelvin					

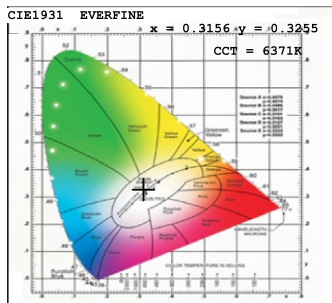

CIE1931 Chromaticity Diagram

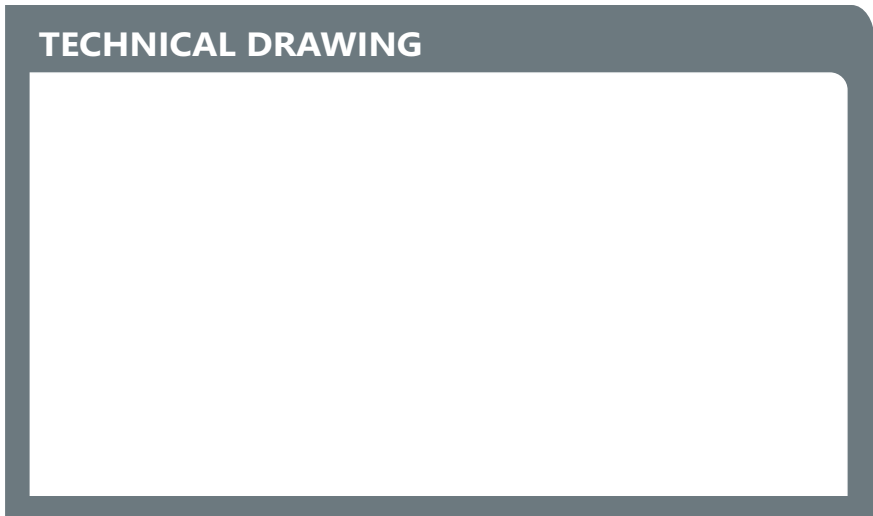

Connector and Steck Systems

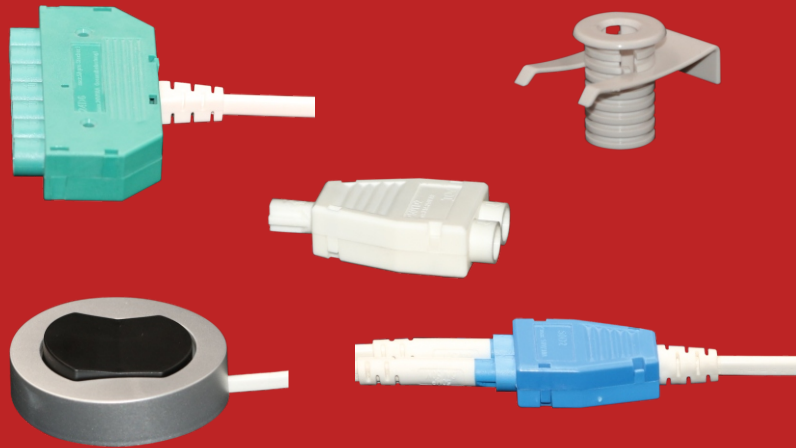

right time, right place !

High quality connecting system for luminaires
Designed according to the IEC60320 standard
for lighting industry applications
24V, 50V, 250V Options
CE, RoHS approval

High Efficiency Lighting and Automation Solutions

idalux®
for a bright future 

7.6mm Mini Connector System

24V 10A
2 pole low voltage

DESCRIPTION:

Designed according to the IEC60320 standard
Applicable in office, kitchen, bathroom, shop and household furniture, display cabinet and mountable lighting
7.6mm outer diameter of mini plug to fit into 8mm furniture holes
Connection: max.10A, 24V
2x0.75mm² cable.
3 years warranty time.
Certificates: CE, ROHs.

For Indoor Applications

High Efficiency Lighting and Automation Solutions

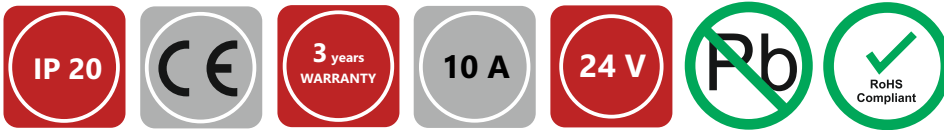
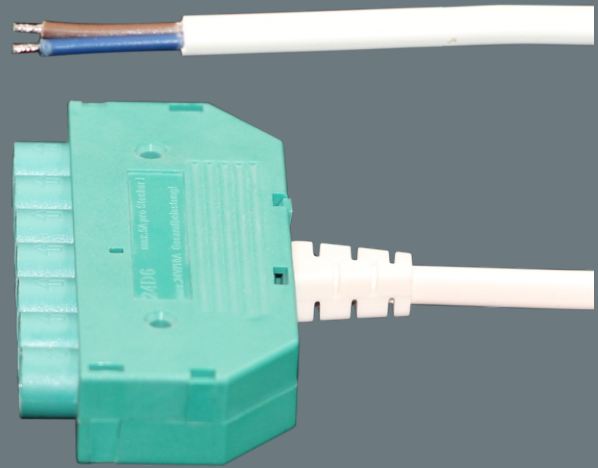
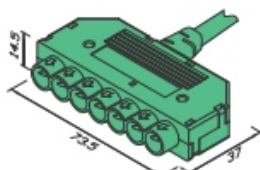
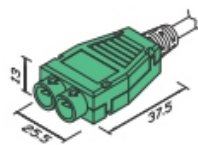

Photo	Description	Photo	Description
	<p>Supply Lead/6-way distributor</p> <ul style="list-style-type: none"> • 6-way distributor (1 way closed) • terminal ends • 24V/10A • 2x0.75mm² white cable • green 		<p>Supply Lead</p> <ul style="list-style-type: none"> • mini female socket • 24V/6A • terminal ends • 2x0.75mm² white cable • green
	<p>Y-Distributor</p> <ul style="list-style-type: none"> • 24V/10A • 1 mini plug + 2 mini sockets • green 		<p>Supply Lead/2-way distributor</p> <ul style="list-style-type: none"> • 2-way distributor • terminal ends • 24V/10A • 2x0.75mm² white cable • green

DIMENSIONS



6-way distributor(1 way closed)



2-way distributor

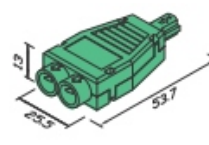

Y-distributor

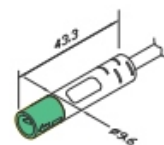

Mini female socket

7.6mm Mini Connector System

24V 10A
2 pole low voltage

DESCRIPTION:

Designed according to the IEC60320 standard
Applicable in office, kitchen, bathroom, shop and household furniture, display cabinet and mountable lighting
7.6mm outer diameter of mini plug to fit into 8mm furniture holes

Connection: max.10A, 24V
2x0.75mm² cable.
3 years warranty time.
Certificates: CE, ROHs.

For Indoor Applications

High Efficiency Lighting and Automation Solutions

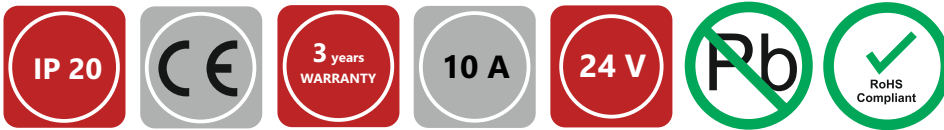
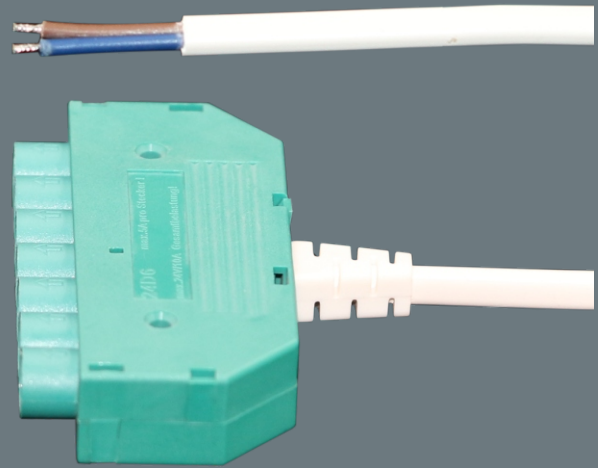
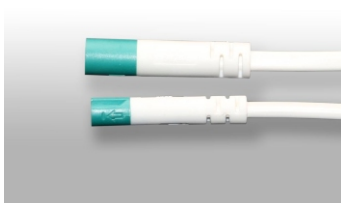
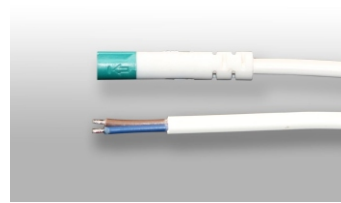

Photo	Description	Photo	Description
-------	-------------	-------	-------------



Extension Lead

- mini male plug
- mini female socket
- 24V/6A
- 2x0.75mm² white cable
- green



Supply Lead

- mini male plug
- 24V/6A
- end tin
- 2x0.75mm² white cable
- green

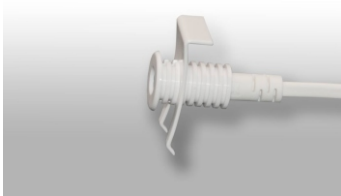

Build-in Mounted Socket

- 24V/10A
- white



DIMENSIONS

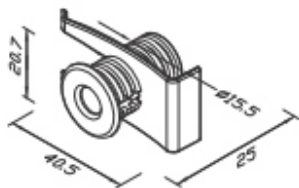

Build-in socket

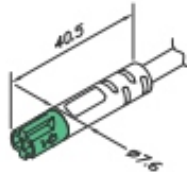

Mini male plug



24V

7.6mm Mini Connector System

50V 10A
2 pole low voltage

DESCRIPTION:

Designed according to the IEC60320 standard
Applicable in office, kitchen, bathroom, shop and household furniture, display cabinet and mountable lighting
7.6mm outer diameter of mini plug to fit into 8mm furniture holes
Connection: max.10A, 50V
2x0.75mm² cable.
3 years warranty time.
Certificates: CE, ROHs.

For Indoor Applications

High Efficiency Lighting and Automation Solutions

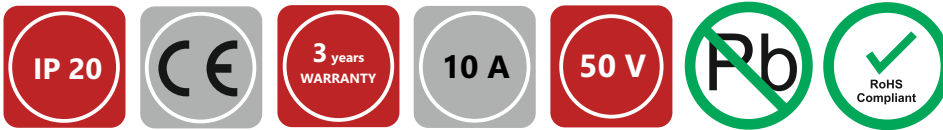
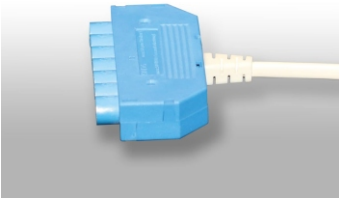
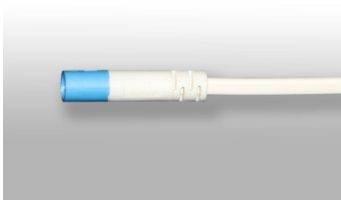
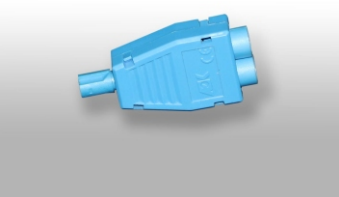
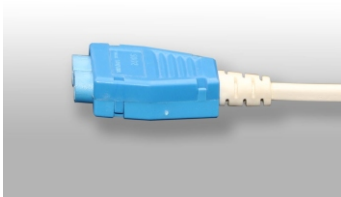
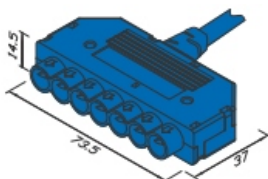
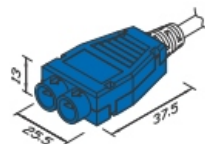

Photo	Description	Photo	Description
	<p>Supply Lead/6-way distributor</p> <ul style="list-style-type: none"> • 6-way distributor (1 way closed) • terminal ends • 50V/10A • 2x0.75mm² white cable • blue 		<p>Supply Lead</p> <ul style="list-style-type: none"> • mini female socket • 50V/6A • terminal ends • 2x0.75mm² white cable • blue
	<p>Y-Distributor</p> <ul style="list-style-type: none"> • 50V/10A • 1 mini plug + 2 mini sockets • blue 		<p>Supply Lead/2-way distributor</p> <ul style="list-style-type: none"> • 2-way distributor • terminal ends • 50V/10A • 2x0.75mm² white cable • blue

DIMENSIONS



6-way distributor(1 way closed)



2-way distributor

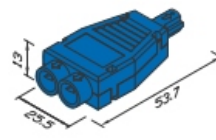

Y-distributor

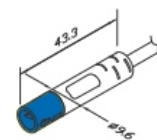

Mini female socket

7.6mm Mini Connector System

50V 10A
2 pole low voltage

DESCRIPTION:

Designed according to the IEC60320 standard
Applicable in office, kitchen, bathroom, shop and household furniture, display cabinet and mountable lighting
7.6mm outer diameter of mini plug to fit into 8mm furniture holes
Connection: max.10A, 50V
2x0.75mm² cable.
3 years warranty time.
Certificates: CE, ROHs.

For Indoor Applications

High Efficiency Lighting and Automation Solutions

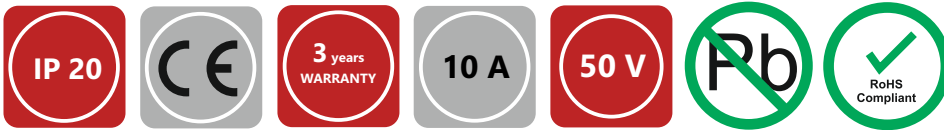
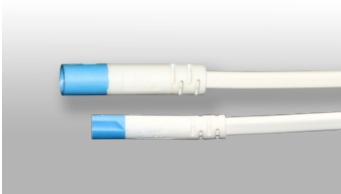
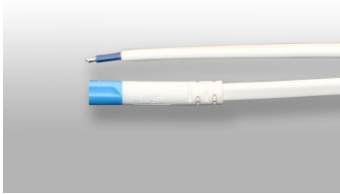
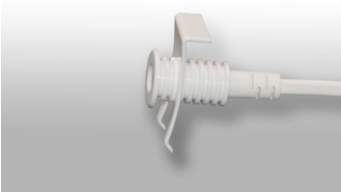

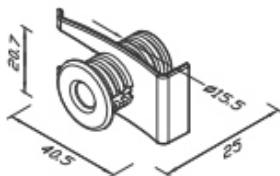
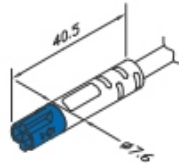

Photo	Description	Photo	Description
	Extension Lead <ul style="list-style-type: none"> • mini male plug • mini female socket • 50V/6A • 2x0.75mm² white cable • blue 		Supply Lead <ul style="list-style-type: none"> • mini male plug • 50V/6A • end tin • 2x0.75mm² white cable • blue
	Build-in Mounted Socket <ul style="list-style-type: none"> • 50V/10A • white 		

DIMENSIONS



Build-in socket



Mini male plug



50V

7.6mm Mini Connector System

250V 2.5A
2 pole high voltage

DESCRIPTION:

Designed according to the IEC60320 standard
Applicable in office, kitchen, bathroom, shop and household furniture, display cabinet and mountable lighting
7.6mm outer diameter of mini plug to fit into 8mm furniture holes
Connection: max.2.5A, 250V
2x0.75mm² cable.
3 years warranty time.
Certificates: CE, ROHs.

For Indoor Applications

High Efficiency Lighting and Automation Solutions

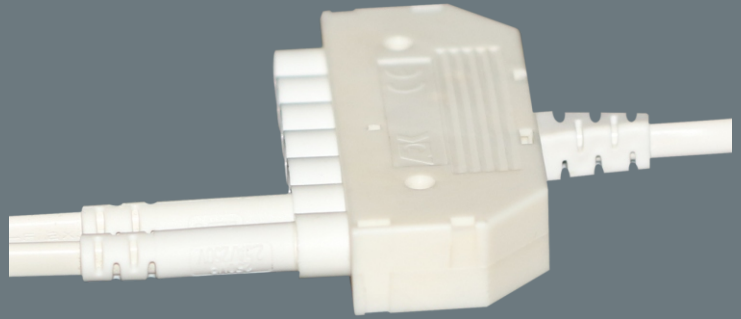
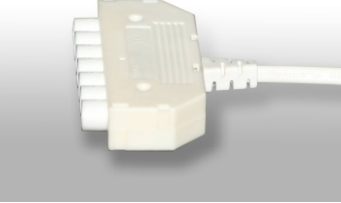

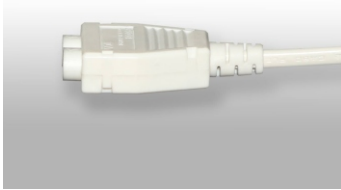
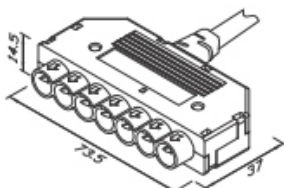
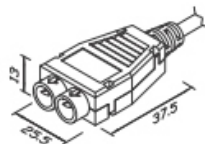

Photo	Description	Photo	Description
	<p>Supply Lead/6-way distributor</p> <ul style="list-style-type: none"> • 6-way distributor (1 way closed) • terminal ends • 250V/2.5A • 2x0.75mm² white cable • white 		<p>Supply Lead</p> <ul style="list-style-type: none"> • mini female socket • 250V/6A • terminal ends • 2x0.75mm² white cable • white
	<p>Y-Distributor</p> <ul style="list-style-type: none"> • 250V/2.5A • 1 mini plug + 2 mini sockets • white 		<p>Supply Lead/2-way distributor</p> <ul style="list-style-type: none"> • 2-way distributor • terminal ends • 250V/2.5A • 2x0.75mm² white cable • white

DIMENSIONS



6-way distributor(1 way closed)



2-way distributor

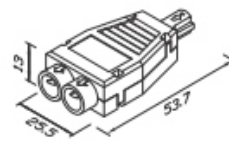

Y-distributor

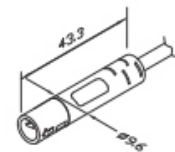

Mini female socket

7.6mm Mini Connector System

250V 2.5A
2 pole high voltage

DESCRIPTION:

Designed according to the IEC60320 standard
Applicable in office, kitchen, bathroom, shop and household furniture, display cabinet and mountable lighting
7.6mm outer diameter of mini plug to fit into 8mm furniture holes

Connection: max.2.5A, 250V
2x0.75mm² cable.
3 years warranty time.
Certificates: CE, ROHs.

For Indoor Applications

High Efficiency Lighting and Automation Solutions

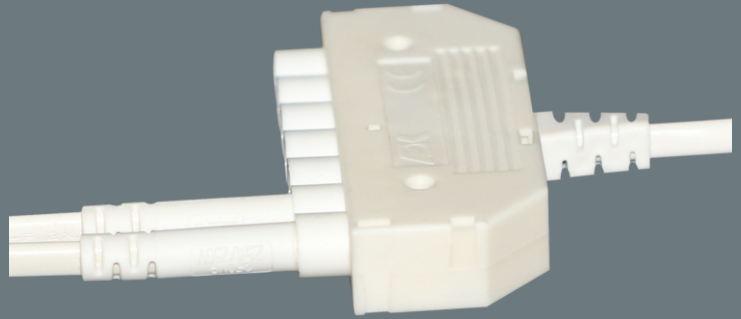
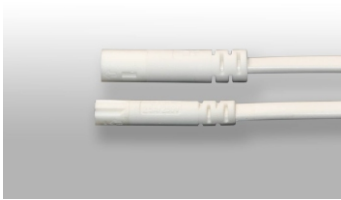
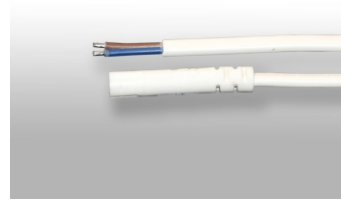

Photo	Description	Photo	Description
-------	-------------	-------	-------------



Extension Lead

- mini male plug
- mini female socket
- 250V/2.5A
- 2x0.75mm² white cable
- white



Supply Lead

- mini male plug
- 250V/2.5A
- end tin
- 2x0.75mm² white cable
- white

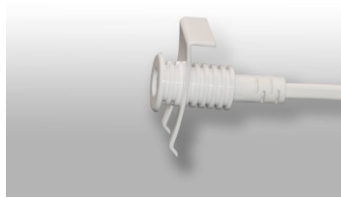

Build-in Mounted Socket

- 250V/2.5A
- white

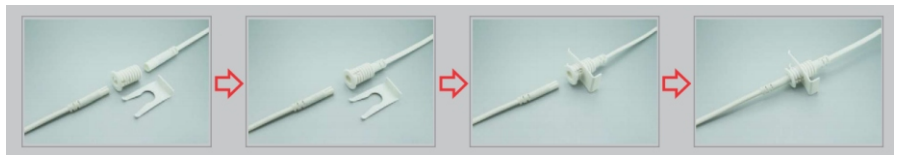

DIMENSIONS

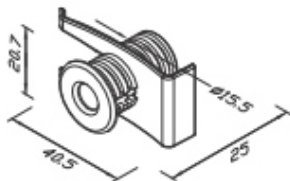

Build-in socket

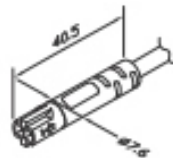

Mini male plug



250V

Ø65mm Switch System

250V 2.5A
2 pole low and high voltage

DESCRIPTION:

Applicable in office, kitchen, bathroom, shop and household furniture, display cabinet and mountable lighting
65mm outer diameter
Surface or recess mounted with screw fixing
Connection: max.2.5A, 250V
2x0.75mm² cable.
3 years warranty time.

For Indoor Applications

High Efficiency Lighting and Automation Solutions

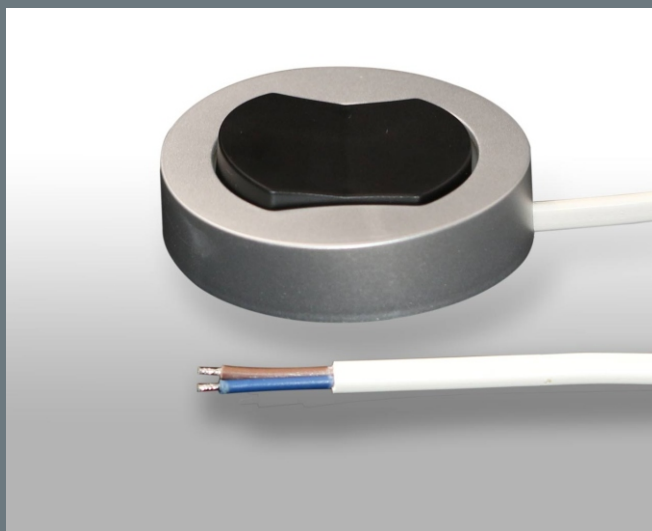
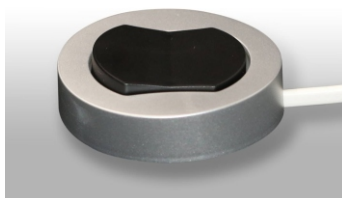
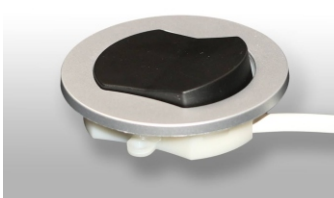

Photo	Description	Photo	Description
-------	-------------	-------	-------------



Surface Mounted Switch Ø65

- end male plug
- 250V/2.5A
- 2x0.75mm² white cable
- silver colour



Recess Mounted Switch Ø65

- end male plug
- 250V/2.5A
- 2x0.75mm² white cable
- silver colour

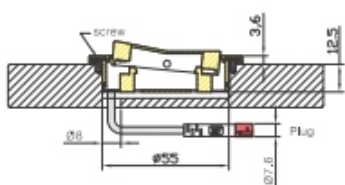

Installation: Recess Mounted

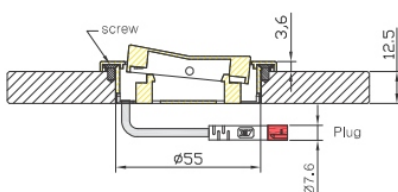

Installation: Recess Mounted

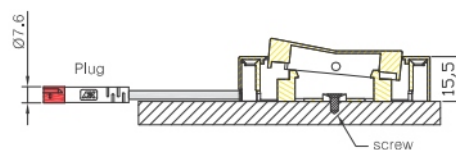

Installation: Surface Mounted

DIMENSIONS

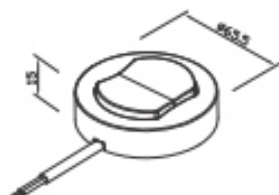

Description: Switch/Schalter

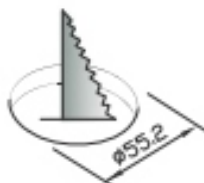

Board hole

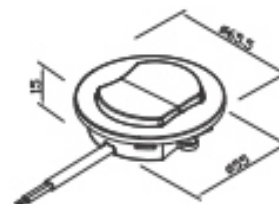

Description: Switch/Schalter

AQL TEKNOLOJİ AYDINLATMA
İthalat İhracat San. Ve Tic. Ltd. Şti.

Gürsu Organize Sanayi Bölgesi
Kurtuluş Mh. Silsile Sk. No: 64
Gürsu BURSA TURKEY
T: +90 224 371 1 371
E: info@idalux.com.tr



www.idalux.com.tr